



For Trading & Industries



Metal Tech

“Bring our quality to your projects”

Cable Trays Catalogue

Metal Tech

“Bring our quality to your projects”

Metal Tech is an Egyptian company works in sheet metal forming and specialized in cable tray fabrication Since 2012, Metal Tech decided to add a good value to cable management in the market so, we started investing our knowledge and expertise in metal cable tray industry.

In other words, we aim to produce best cable management products to fulfil all projects requirements. Therefore, we started our industry using our percise machines & skilled team.

We pledged to keep improving our relation with partners in success by keep supporting them and supply high quality products.

due to our quality and commitment, we had the trust of many companies in egyptian market.

We Provide a wide variety of cable management products:

- 1- Perforated Cable Tray
- 2- Cable Ladder
- 3- Cable Trunk
- 4- Support systems

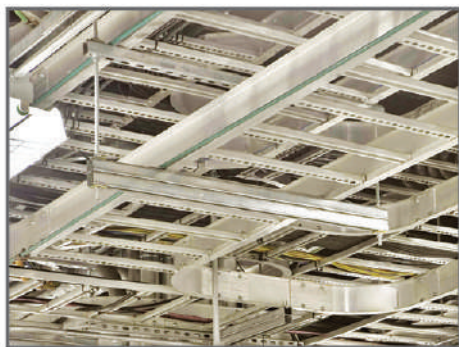

MT philosophy is to maintain, and improve, our record of providing work of the highest quality trays. in accordance with the clients' requirements, time, and budget.

Quality is the cornerstone that has been vital to MT Tray for long time of growth, and success. As individual ideas, quality, health, safety and environment represent very specific business concepts.

Quality Policy Statement

Our success is based on the quality and commitment of our experienced and professional management personnel. Ongoing development of our operations and upgrading of equipment and facilities ensure that we do our best

We are not only committed to produce high quality trays, but also in providing our clients with a quality service throughout the continuous technical support.

We are committed to:

- Reduce incidents and customer complaints
- Identify improvements to existing working practices
- Provide a quality project management service through the delivery of projects and end products
- Continually evaluate and improve the effectiveness of QHSE Plans, Work Plans, etc.

Metal Tech is committed to providing high-quality trays products to our Clients which accurately interprets their requirements and satisfies their expectations in an economic, and efficient manner.



In other words, MT dedicated itself to deliver defect-free cable tray products at the most competitive possible cost.

Above all, we regard Health, Safety and Environment management as an integral element of our business. as a result we are committed to protect people, equipment, physical assets.

carrying out our work activities in a way that meets the interests of our clients, the general public and employees regarding our impact on the environment.

Our Quality, Health, Safety and Environment Management System is based on the requirements of: ISO 9001:2015, 14001:2015, OHSAS 18001:2007 and statutory & regulatory obligations

our objective is to ensure that our products fulfill the aims, objectives and satisfaction of our customers.

Metal Tech will achieve this objective through :

- Ensure continuous improvement and client satisfaction.
- Take care of our own safety and the safety of others who may be affected by what we do or fail to do.
- Minimize waste, pollution risk and use energy wisely.
- Promote a safe working environment where our employees can develop their capabilities and skills.
- Maintain open communication with customers and evaluate customer satisfaction.
- Identify, investigate & correct quality shortfalls & take appropriate action to prevent recurrence.



Perforated Tray



Perforated Tray

Steel - Stainless steel - Aluminum

Snap on tray (standard)

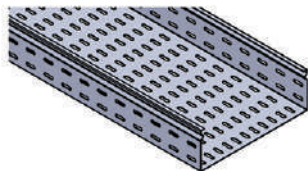

Minimum Height = 50mm
Maximum Height = 150 mm

U shape

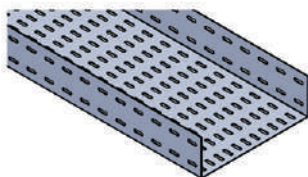

Minimum Height = 50mm
Maximum Height = 150 mm

Internal flange

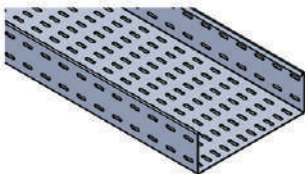

Minimum Height = 50mm
Maximum Height = 150 mm

External flange

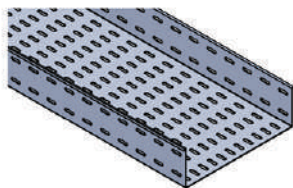

Minimum Height = 50mm
Maximum Height = 150 mm

* cable tray width \geq side height

Manufacture

All cable tray manufactured according to NEMA STANDARD VE1.
We can express about cable tray by the following example .

Metal Tech Description

EX.

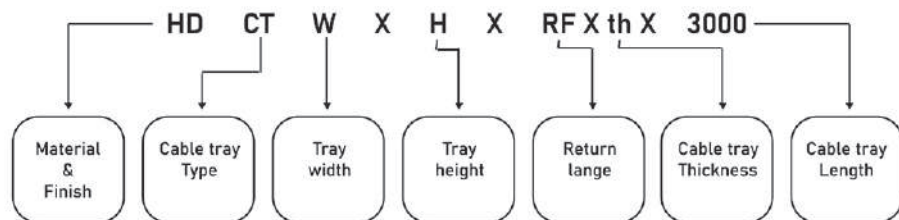

Material & Finish

Steel 37

HD Hot dip galvanized after fabrication .
PG Pre galvanized .
EP Electro plated .
ES Electro static painted .

Stainless steel

SS316 Stain less steel 316 .
SS316L Stain less steel 316L .
SS304 Stain less steel 304 .
SS304L Stain less steel 304L .

Aluminum

AL Aluminum alloy 6063 .

Cable Tray Type:

CT Cable tray perforated type (Snap on tray) .
CTU Cable tray perforated U shape .
CTI Cable tray perforated internal flange .
CTE Cable tray perforated external flange .

Cable Tray width:

Cable tray width (W) its value varies from 50 mm to 1000 mm

Cable Tray height:

Cable tray height (H) standard value 50 mm to 150 mm

Return Flange:

Cable tray return flange standard value is 10 mm.
in case of tray U shape return flange value is 0.

Cable Tray Thickness:

Cable tray thickness value is 1 - 1.25 - 1.5 - 2 mm

Cable tray Length:

Cable tray length standard value is 2000 - 2500 - 3000 mm
(6000 mm length is as client required) .

Cable Tray Perforated (Snap on Tray)

Straight Element

Steel - Stainless Steel - Aluminum

- Snap on tray is standard cable tray produced in Metal Tech .

- Standard length 2000 - 2500 - 3000 mm

Available sizes for Cable Tray

Width (W)	Height (H)	Thickness (T)
50		
100		
200		1
300	50	
400		1.25
500	To	
600		1.5
700	150	
800		2
900		
1000		

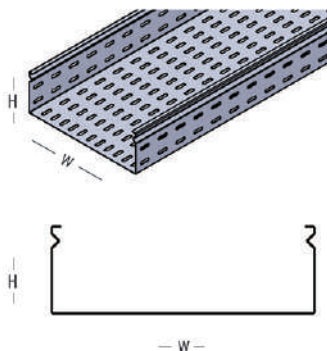

Cable trays width up to 300 is available with 1.5 mm thickness

Cable trays width from 400 mm to 1000 mm is available with 2 mm thickness

Example for order

Metal Tech Description

Ex.

HD CT 300 x 50 x 1.5 x 3000

Hot dip galvanized after fabrication cable tray perforated, 300 mm width, 50 mm side height, 1.5 mm thickness, 3000 mm length .

Fitting

Steel - Stainless steel - Aluminum

Example for order Metal Tech Description

EX.

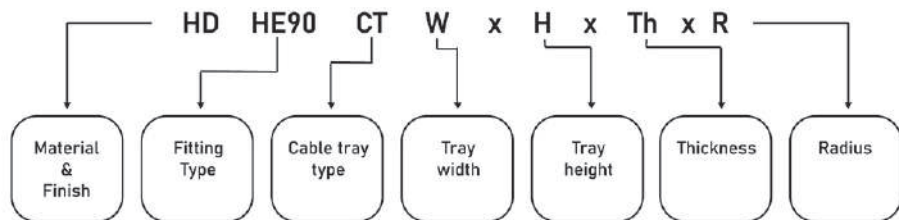

Fitting Type means

HE90: Horizontal Elbow 90 .
HE45: Horizontal Elbow 45 .
HT: Horizontal Tee .
HRR: Horizontal Right Reducer .
HCR: Horizontal Center Reducer .
HLR: Horizontal Left Reducer .

VOE 90 : Vertical Outside elbow 90 .
VIE 90 : Vertical Inside elbow 90 .
VOE 45: Vertical Outside elbow 45 .
VIE 45 : Vertical Inside elbow 90 .
VJOE : Vertical Jointed Outside elbow .
VJIE : Vertical Jointed Inside elbow .
VT : Vertical Tee .

Standard Radius :

Available standard Radiuses are: 300 - 600 - 900

Horizontal Elbow 90°

Width (W)	Height (H)	Radius (R)
50		
100		
200		
300	50	300
400		
500	To	600
600		
700	150	900
800		
900		
1000		

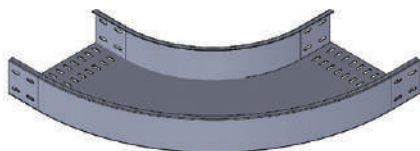

Horizontal Elbow 45°

Width (W)	Height (H)	Radius (R)
50		
100		
200		
300	50	300
400		
500	To	600
600		
700	150	900
800		
900		
1000		

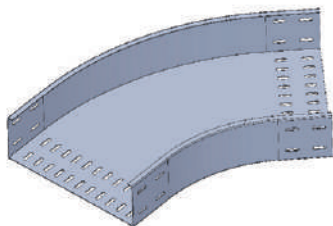

Vertical Inside Elbow 90°

Width (W)	Height (H)	Radius (R)
50		
100		
200		
300	50	300
400		
500	To	600
600		
700	150	900
800		
900		
1000		

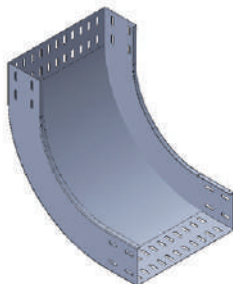

Vertical Inside Elbow 45°

Width (W)	Height (H)	Radius (R)
50		
100		
200		
300	50	300
400		
500	To	600
600		
700	150	900
800		
900		
1000		

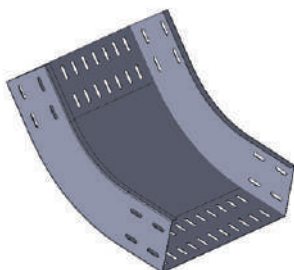

Vertical Outside Elbow 90°

Width (W)	Height (H)	Radius (R)
50		
100		
200		
300	50	300
400		
500	To	600
600		
700	150	900
800		
900		
1000		

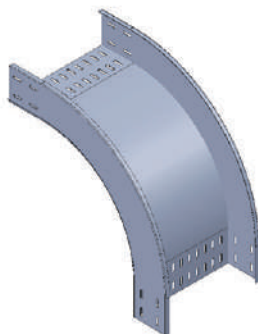

Vertical Outside Elbow 45°

Width (W)	Height (H)	Radius (R)
50		
100		
200		
300	50	300
400		
500	To	600
600		
700	150	900
800		
900		
1000		

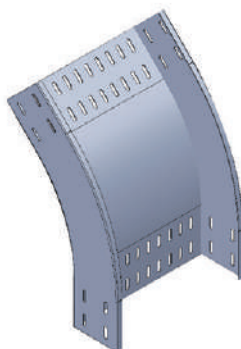

Horizontal TEE

Width (W)	Height (H)	Radius (R)
50		
100		
200		
300	50	300
400		
500	To	600
600		
700	150	900
800		
900		
1000		

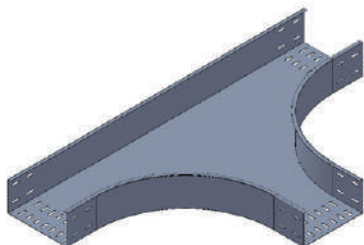

Vertical TEE

Width (W)	Height (H)	Radius (R)
50		
100		
200		
300	50	300
400		
500	To	600
600		
700	150	900
800		
900		
1000		

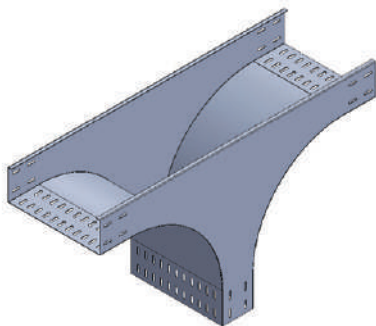

Horizontal Cross

Width (W)	Height (H)	Radius (R)
50		
100		
200		
300	50	300
400		
500	To	600
600		
700	150	900
800		
900		
1000		

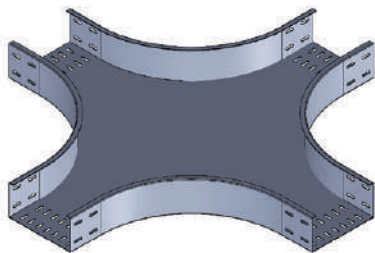

Horizontal Reducer Center Reducer

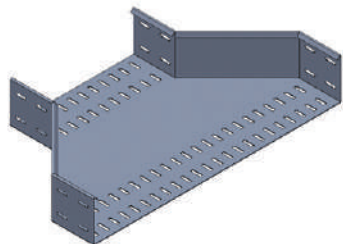

Right Hand Reducer

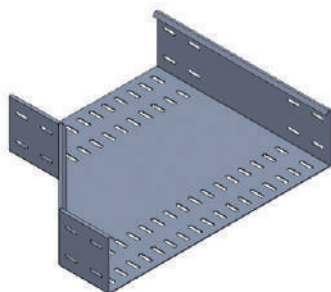

Left Hand Reducer

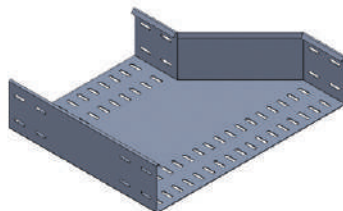

Cable tray covers

Straight element cover

Steel - Stainless steel - Aluminum

All properties of cover are the same properties of its tray .
Standard length is 2000 - 2500 - 3000 mm

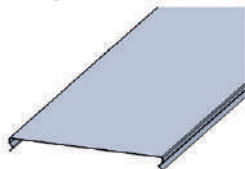

(CTC) Snap on cover
(standard)

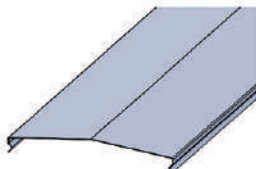

(CTPC)
pyramid shape cover

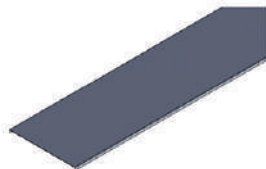

(CTUC)
U shape cover

Metal Tech Description

EX.

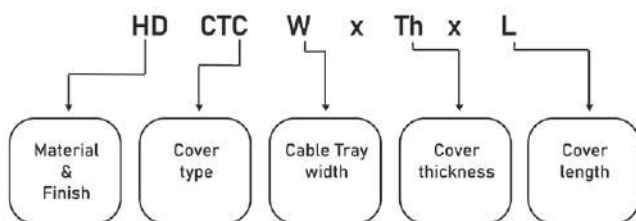

Example for order

HD CTC 300 x 1 x 3000

Hot dip galvanized after fabrication cover for cable tray 300 mm width, 1 mm thickness, 3000 mm length .

Available sizes of Covers

Description	Width (W)	Thickness (T)
Cover 50	50	
Cover 100	100	
Cover 200	200	1
Cover 300	300	
Cover 400	400	1.25
Cover 500	500	
Cover 600	600	1.5
Cover 700	700	
Cover 800	800	2
Cover 900	900	
Cover 1000	1000	

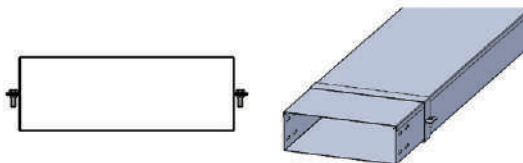

Fitting Covers

Steel - Stainless steel - Aluminum

All properties of cover are the same of its cover of straight element



Horizontal elbow 90° cover
(HE90CTC)



Horizontal elbow 45° cover
(HE45CTC)



Vertical inside elbow 90° cover
(VIE90CTC)



Vertical inside elbow 45° cover
(VIE45CTC)

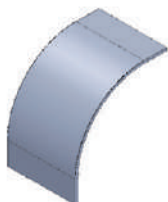

Vertical outside elbow 90° cover
(VOE90CTC)

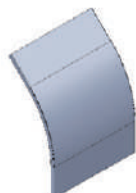

Vertical outside elbow 45° cover
(VOE45CTC)



Horizontal Tee cover
(HTCTC)

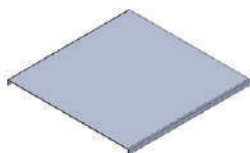

Vertical Tee cover
(VTCTC)



Horizontal Cross cover
(HCCTC)



Horizontal Left Reduce cover
(HLRCTC)



Horizontal Center Reduce cover
(HCRCTC)



Horizontal Right Reduce cover
(HRRCTC)

Accessories

Steel - Stainless steel - Aluminum

All properties of accessories are the same of its straight element

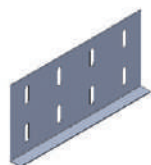

Splice plate
(CTSP)



Horizontal Adjustment joint
(CT HAJ)



Vertical Adjustment joint
(CT VAJ)

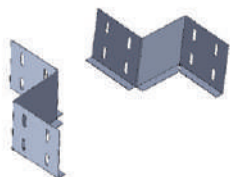

Center Reducing Splice plate
(CT CRSP)

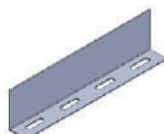

Straight element separator
(CT SPP)

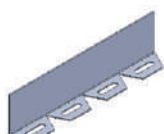

Horizontal elbow separator
(ct hsep)



Blind end
(CT BE)



Vertical outside separator
(CT VOSEP)



Steel bolt with nut & washer



Vertical inside separator
(CT VISEP)



Cable Ladder

Cable Ladder

Steel - Stainless steel

Available sizes

Width (W)	Height (H)	Thickness (T)	Length (L)
100	50	1.5	2000
200			
300			
400			
500			
600	To	&	&
700	150	2	3000
800			
900			
1000			
1200			

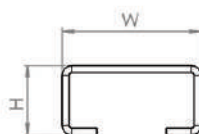
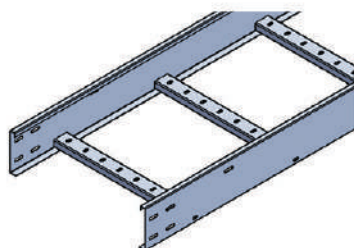

Metal Tech Description

EX.

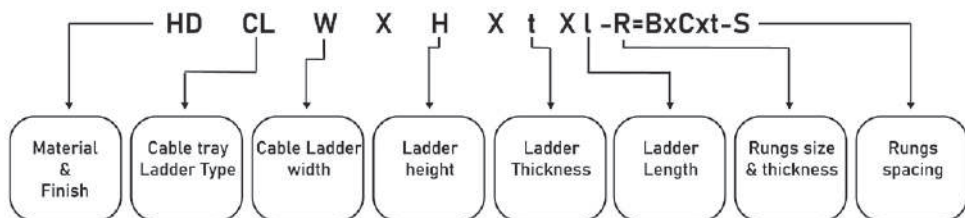

Example for order

Metal Tech Description

Ex.

HD CL 300 x 150 x 2 x 3000 - R40x25x2 S=225

Hot dip galvanized after fabrication cable tray ladder type, 300 mm width, 150 mm side height, 3000 mm length, rungs size 40x25mm, 2mm thickness, rungs spacing 225 mm from center .

Material & Finish

Steel

HD Hot dip galvanized after fabrication according to ASTM A 123 .
 PG Pre galvanized before fabrication according to ASTM A 653SS .
 EP Electro plated after fabrication ASTM B 633 .
 ES Electro static painted .

Stainless steel

SS316 Stain less steel 316 .
 SS316L Stain less steel 316L .
 SS304 Stain less steel 304 .
 SS304L Stain less steel 304L ASTM A240 .

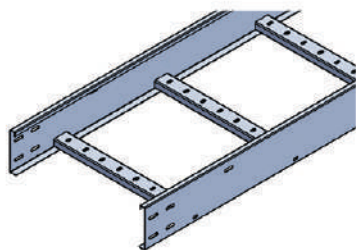

Cable tray type:

Cable tray type CL = cable ladder

Cable Tray width:

Cable tray Ladder type width (W) = (100-200-300-400-500-600-700-800-900-1000-1200) mm

Cable Tray height:

Cable tray ladder type height (H) = (50-100-125-150-175-200) mm
 loading depth = Nominal Depth - C (Rung height)

Ladder Thickness:

Light duty ladder thickness $t = 1.5$ mm .
 Heavy duty ladder thickness $t = 2$ mm .

Ladder Length:

Ladder standard length $L = 2000$ & 3000 & 6000 mm .

Rungs size:

B	C
30	15
40	20
40	25
50	25

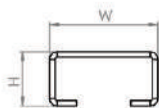

Rungs spacing

S = standard spacing = (300-250-225) mm.

Fixing Rungs on ladder sides

Welded Rungs

Steel
Welded with Co2

Stainless steel
Welded with Argon

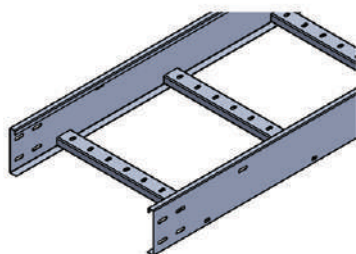

Welded rungs

Bolted Rungs

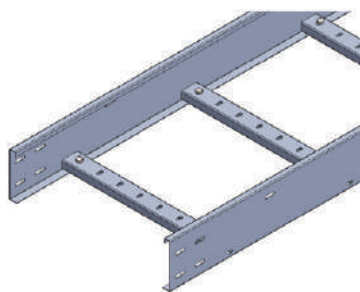

Bolted rungs

Suitable for pre galvanized steel cable ladder

Cable tray Ladder type (Fitting)

Steel - Stainless steel

All cable trays ladder type fitting has the same properties of its cable ladder in (size - thickness - finish)

Example for order Metal Tech Description

EX.

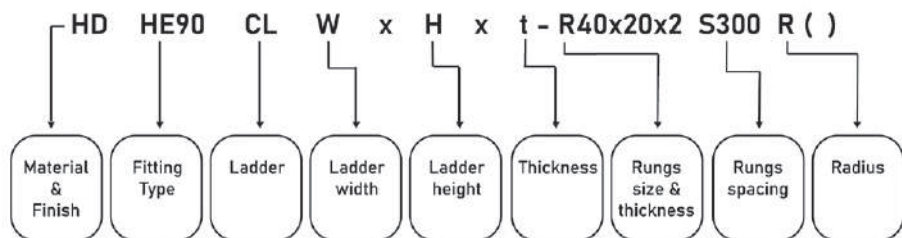

Fitting Type means

HE90: Horizontal Elbow 90 .
 HE45: Horizontal Elbow 45 .
 HT: Horizontal Tee .
 HC: Horizontal Cross .
 HRR: Horizontal Right Reducer .
 HCR: Horizontal Center Reducer .
 HLR: Horizontal Left Reducer .

VEO 90 : Vertical elbow 90 Outside .
 VEI 90 : Vertical elbow 90 Inside .
 VEO 45: Vertical elbow 45 Outside .
 VEI 45 : Vertical elbow 90 Inside .
 VJOE : Vertical Jointed Outside elbow .
 VJIE : Vertical Jointed Inside elbow .
 VT : Vertical Tee .

Radius :

Available standard Radiuses are: 300 - 600 - 900

Horizontal Elbow 90°

Width (W)	Height (H)	Radius (R)
100		
200		
300		
400	50	300
500		
600	To	600
700		
800	200	900
900		
1000		

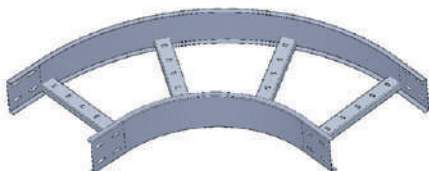

Horizontal Elbow 45°

Width (W)	Height (H)	Radius (R)
100		
200		
300		
400	50	300
500		
600	To	600
700		
800	200	900
900		
1000		

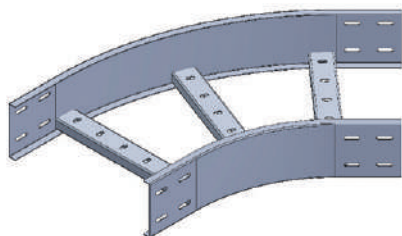

Vertical Inside Elbow 90°

Width (W)	Height (H)	Radius (R)
100		
200		
300		
400	50	300
500		
600	To	600
700		
800	200	900
900		
1000		

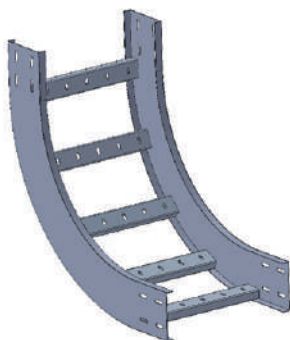

Vertical Inside Elbow 45°

Width (W)	Height (H)	Radius (R)
100		
200		
300		
400	50	300
500		
600	To	600
700		
800	200	900
900		
1000		

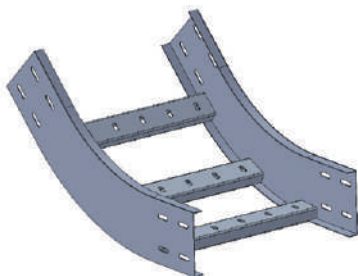

Vertical Outside Elbow 90°

Width (W)	Height (H)	Radius (R)
100		
200		
300		
400	50	300
500		
600	To	600
700		
800	200	900
900		
1000		

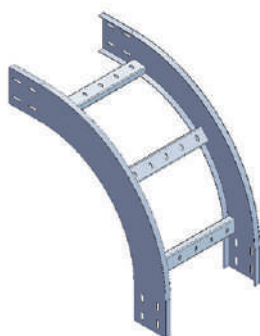

Vertical Outside Elbow 45°

Width (W)	Height (H)	Radius (R)
100		
200		
300		
400	50	300
500		
600	To	600
700		
800	200	900
900		
1000		

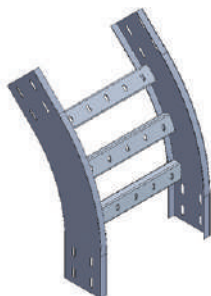

Horizontal TEE

Width (W)	Height (H)	Radius (R)
100		
200		
300		
400	50	300
500		
600	To	600
700		
800	200	900
900		
1000		

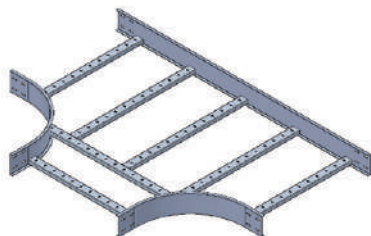

Vertical TEE

Width (W)	Height (H)	Radius (R)
100		
200		
300		
400	50	300
500		
600	To	600
700		
800	200	900
900		
1000		

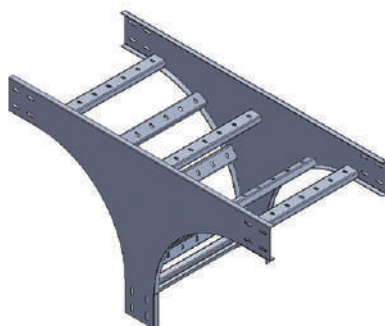

Horizontal Cross

Width (W)	Height (H)	Radius (R)
100		
200		
300		
400	50	300
500		
600	To	600
700		
800	200	900
900		
1000		

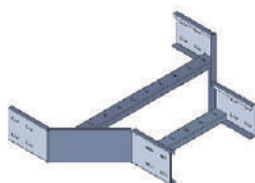

Horizontal Center Reducer

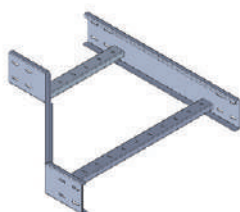

Horizontal Right Reducer

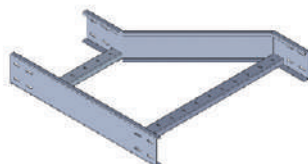

Horizontal Left Reducer

The background image shows a complex network of yellow cable trunks mounted on a silver metal frame. The trunks are connected by various brackets and clamps, creating a structured and organized routing system for cables. The perspective is from a low angle, looking up at the ceiling structure.

Cable Trunk

Solid Cable Trunk

Straight Element

Steel - Stainless steel - Aluminum

Snap on tray (standard)

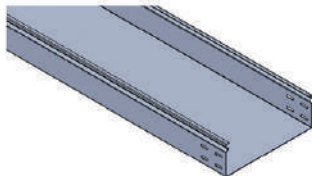

Minimum Height = 50 mm
Maximum Height = 150 mm

U shape

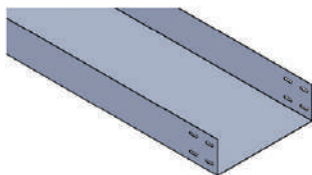

Minimum Height = 50 mm
Maximum Height = 150 mm

Internal flange

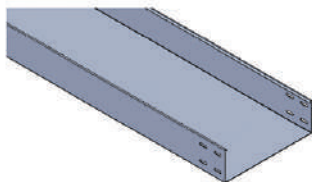

Minimum Height = 50 mm
Maximum Height = 150 mm

External flange

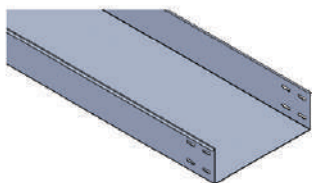

Minimum Height = 50 mm
Maximum Height = 150 mm

*cable trunk width \geq side height

Manufacture

We can express about cable trunk by the following example .

Metal Tech Description

EX.

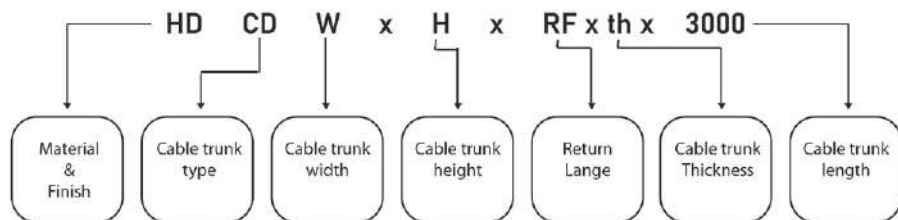

Material & Finish

Steel 37

HD Hot dip galvanized after fabrication .

PG Pre galvanized .

EP Electro plated .

ES Electro static painted .

Stainless steel

SS316 Stain less steel 316 .

SS316L Stain less steel 316L .

SS304 Stain less steel 304 .

SS304L Stain less steel 304L .

Aluminum

AL Aluminum alloy 6063 .

Cable Trunk Type

CD Cable trunk type (snap on trunk)

CDU Cable trunk U shape

CDI Cable trunk internal flange

CDE Cable trunk external flange

Cable Trunk width

Cable trunk width (W) its value varies from 50 mm to 1000 mm

Cable Trunk height

Cable trunk height (H) standard value 50 mm to 150 mm

Return Flange

Cable trunk return flange standard value is 10 mm
in case of trunk U shape return flange value is 0

Cable Trunk Thickness

Cable trunk thickness value is from 1 to 2 mm

Cable Trunk Length

Cable trunk length standard value is 2000, 2500, 3000 mm
(6000 mm legnth is as client required)

Cable Trunk

(Snap on Trunk)

Straight Element

Steel - Stainless Steel - Aluminum

- Snap on trunk is standard cable trunk produced in Metal Tech

- Standard length 2000 mm - 3000 mm.

Available sizes for cable trunk

Width (W)	Height (H)	Thickness (T)
50		
100		
200		1
300	50	
400		1.25
500	To	
600		1.5
700	150	
800		2
900		
1000		

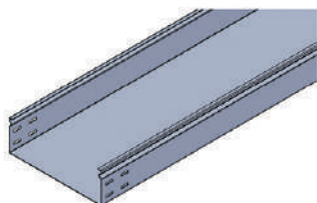

Cable trunk width Up To 300 mm width = 1.5 mm Thickness

Cable trunk width from 400 to 1000 width is available with 2mm Thickness

Example for order

Metal Tech Description

Ex.

HD CD 200 x 100 x 10 x 1.5 x 3000

Hot dip galvanized after fabrication cable trunk type, 200 mm width, 100 mm side height 10 mm return flange 1.5 mm thickness, 3000 mm length .

Cable Trunk (fitting)

Steel - Stainless steel - Aluminum

All cable trunk fitting has the same properties of its cable trunk in (size - thickness - finish)

Example for order Metal Tech Description

EX.

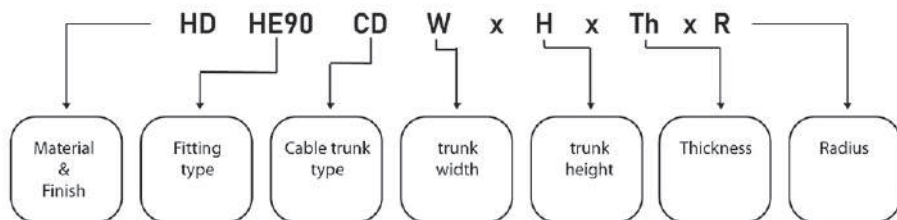

Fitting Type means

HE90: Horizontal Elbow 90 .
 HE45: Horizontal Elbow 45 .
 HT: Horizontal Tee .
 HOT: Horizontal offset Tee .
 HC: Horizontal Cross .
 HRR: Horizontal Right Reducer .
 HCR: Horizontal Center Reducer .
 HLR: Horizontal Left Reducer .

VOE 90 : Vertical Outside elbow 90 .
 VIE 90 : Vertical Inside elbow 90 .
 VOE 45: Vertical Outside elbow 45 .
 VIE 45 : Vertical Inside elbow 90 .
 VJOE : Vertical Jointed Outside elbow .
 VJIE : Vertical Jointed Inside elbow .
 VT : Vertical Tee .

Standard Radius :

Available standard Radiuses are: 300-600-900

Horizontal Elbow 90°

Width (W)	Height (H)	Radius (R)
100		
200		
300		
400	50	300
500		
600	To	600
700		
800	150	900
900		
1000		

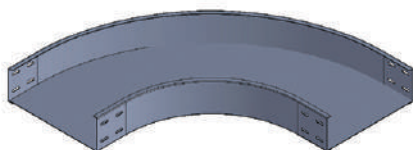

Horizontal Elbow 45°

Width (W)	Height (H)	Radius (R)
100		
200		
300		
400	50	300
500		
600	To	600
700		
800	150	900
900		
1000		

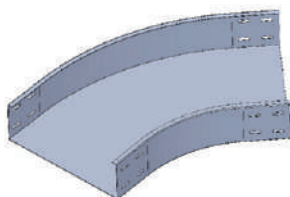

Vertical Inside Elbow 90°

Width (W)	Height (H)	Radius (R)
100		
200		
300		
400	50	300
500		
600	To	600
700		
800	150	900
900		
1000		

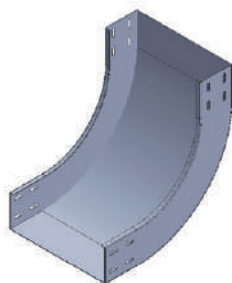

Vertical Inside Elbow 45°

Width (W)	Height (H)	Radius (R)
100		
200		
300		
400	50	300
500		
600	To	600
700		
800	150	900
900		
1000		

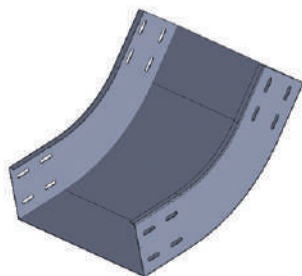

Vertical Outside Elbow 90°

Width (W)	Height (H)	Radius (R)
100		
200		
300		
400	50	300
500		
600	To	600
700		
800	150	900
900		
1000		

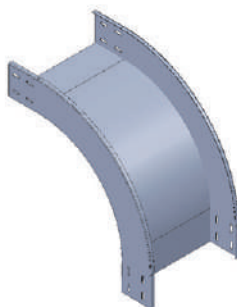

Vertical Outside Elbow 45°

Width (W)	Height (H)	Radius (R)
100		
200		
300		
400	50	300
500		
600	To	600
700		
800	150	900
900		
1000		

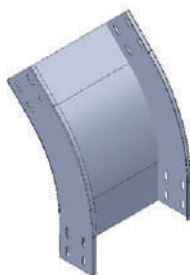

Horizontal TEE

Width (W)	Height (H)	Radius (R)
100		
200		
300		
400	50	300
500		
600	To	600
700		
800	150	900
900		
1000		

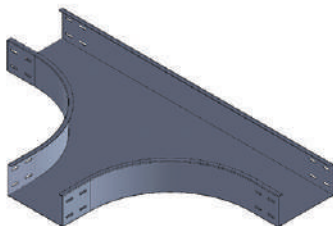

Vertical TEE

Width (W)	Height (H)	Radius (R)
100		
200		
300		
400	50	300
500		
600	To	600
700		
800	150	900
900		
1000		

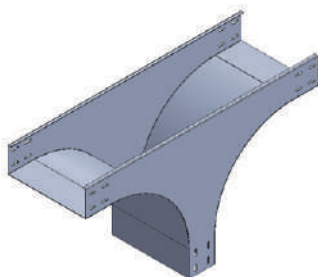

Horizontal Cross

Width (W)	Height (H)	Radius (R)
100		
200		
300		
400	50	300
500		
600	To	600
700		
800	150	900
900		
1000		

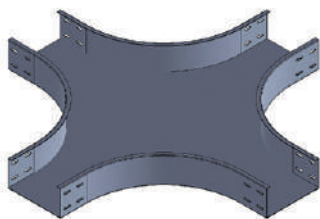

Horizontal Reducer Center Reducer

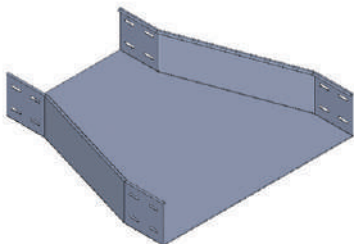

Right Hand Reducer

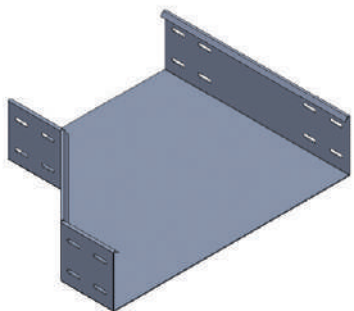

Left Hand Reducer



Cable tray covers

Straight element cover

Steel - Stainless steel - Aluminum

All properties of cover are the same properties of its tray .
Standard length is 2000, 3000 mm .

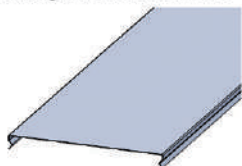

(CTC) Snap on cover
(standard)

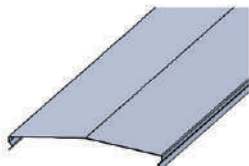

(CTPC)
pyramid shape cover

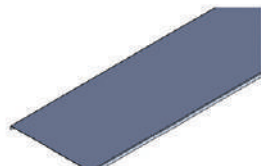

(CTUC)
U shape cover

Metal Tech Description

EX.

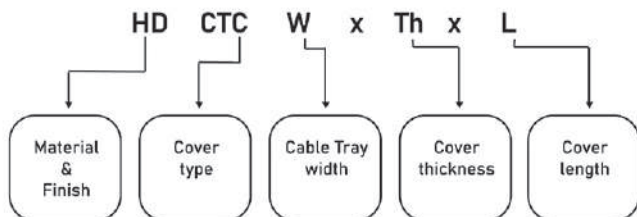

Example for order

HD CTC 300 x 1 x 3000

Hot dip galvanized after fabrication cover for cable tray 300 mm width, 1 mm thickness, 3000 mm length .

Available sizes of cover

Description	Width (W)	Thickness (T)
cover 50	50	1
cover 100	100	
cover 200	200	To
cover 300	300	
cover 400	400	2
cover 500	500	
cover 600	600	

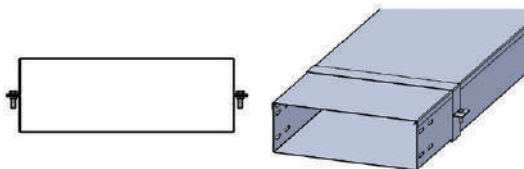

Fitting Covers

Steel - Stainless steel - Aluminum

All properties of cover are the same of its cover of straight element



Horizontal elbow 90° cover
(HE90CTC)



Horizontal elbow 45° cover
(HE45CTC)



Vertical inside elbow 90° cover
(VIE90CTC)



Vertical inside elbow 45° cover
(VIE45CTC)

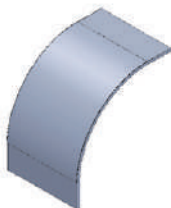

Vertical outside elbow 90° cover
(VOE90CTC)

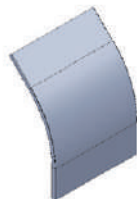

Vertical outside elbow 45° cover
(VOE45CTC)



Horizontal Tee cover
(HTCTC)

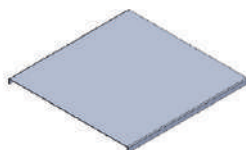

Vertical Tee cover
(VTCTC)



Horizontal Cross cover
(HCCTC)



Horizontal Left Reduce cover
(HLRCTC)



Horizontal Center Reduce cover
(HCRCTC)



Horizontal Right Reduce cover
(HRRCTC)

Accessories

Steel - Stainless steel - Aluminum

All properties of accessories are the same of its straight element

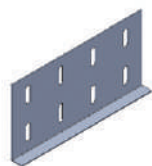

Splice plate
(CTSP)

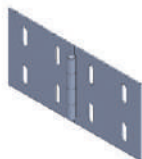

Horizontal Adjustment joint
(CT HAJ)



Vertical Adjustment joint
(CT VAJ)

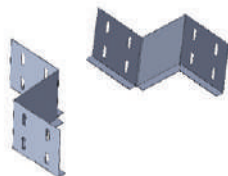

Center Reducing Splice plate
(CT CRSP)

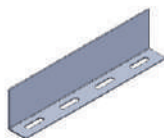

Straight element separator
(CT SPP)

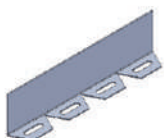

Horizontal elbow separator
(ct hsep)



Blind end
(CT BE)



Vertical outside separator
(CT VOSEP)

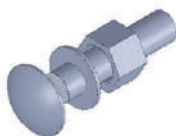

Steel bolt with nut & washer



Vertical inside separator
(CT VISEP)



Wire Mesh Tray

Wire mesh tray (basket type)

Straight Element

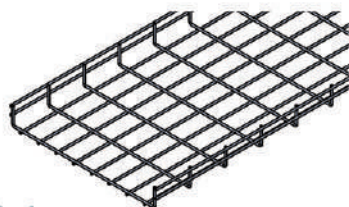
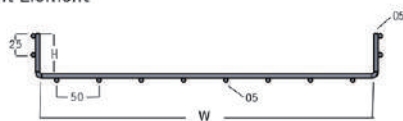

Metal Tech Description

EX.

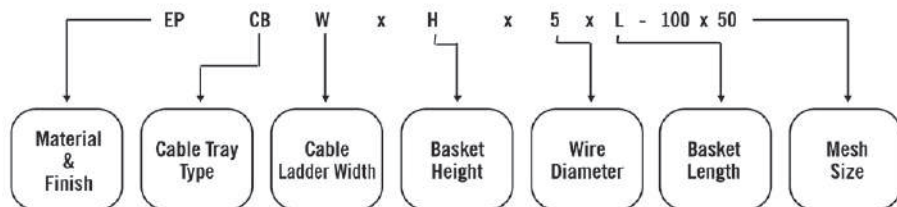

Material

Steel

Basket Cable Tray Systems are produced from high strength steel wires (ASTM A510)

Stainless Steel

- ss 304 stainless steel 304
- ss 304L stainless steel 304L
- ss 316 stainless steel 316
- ss 316L stainless steel 316L

Finish

Steel

- HD Hot dip galvanized after fabrication according to ASTM A 123
- EP Electro plated after fabrication ASTM B 633
- ES Electro static painted

Stainless Steel

Cleaning

Cable Tray Type

Cable tray type CP = cable basket

Cable Tray Width

Cable tray type width W = (100-200-300-400-500-600-700-800-900-1000) mm

Cable Tray Height

Cable tray height H = (50-100-150) mm

Wire Diameter

Wire diameter (4-5-6)mm

Basket Length

Basket standard length L = 2000, 2500, 3000 mm

Mesh Size

Standard mesh size = 100x50 mm

Welding

A fully automated welding process produces continuous wire mesh with press welding machine

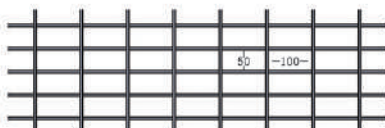

Wire mesh tray

Straight Element - Steel - Stainless Steel

Side 50 mm

Width (W)	Height (H)	Wire Diameter	Length (L)
50	50	4	2000
100			
200			
300			
400			
500			
600			
700			
800			
900			
1000			

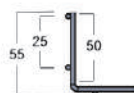
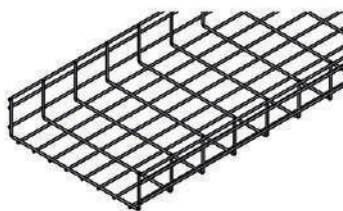

MT Description

EX.

EP CB 300x50x5x2000 - 100x50

Electro plated cable tray basket type, 300 mm width, 50mm side height, wire diameter 5mm

Mesh size 100x50 mm

Wire mesh tray

Straight Element - Steel - Stainless Steel

Side 100 mm

Width (W)	Height (H)	Wire Diameter	Length (L)
50	100	4	2000
100			
200			
300			
400			
500			
600			
700			
800			
900			
1000			

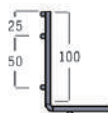
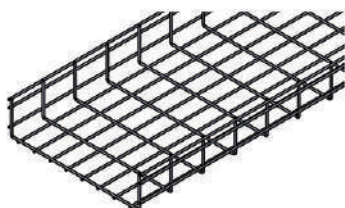

MT Descriptionn

EX.

EP CB 400x100x5x3000 - 100x50

Electro plated cable tray basket type, 400 mm width, 100mm side height, wire diameter 5mm

Mesh size 100x50 mm

Wire mesh tray type (Fitting)

Steel - Stainless Steel

wire basket System is designed to accommodate jobsite changes, Straight sections can be modified to produce bends, tees, crosses or reducers, can be made from any tray width and depth with any available finish

Horizontal Elbow

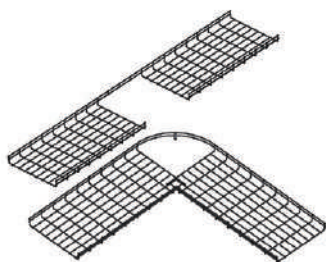

Short Radius

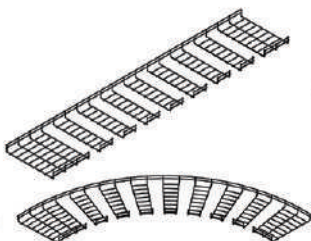

Long Radius

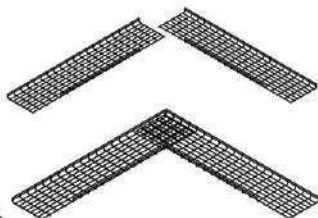

Straight sections

Vertical Elbow

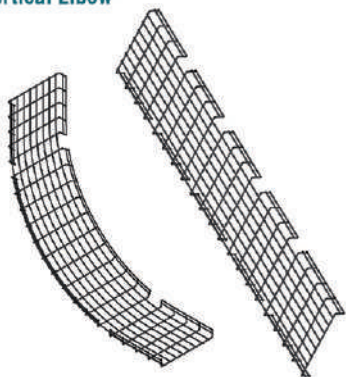

Vertical inside

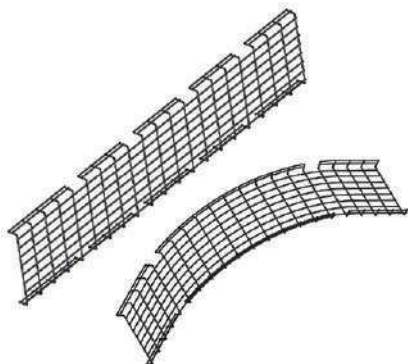

Vertical outside

Horizontal Tee

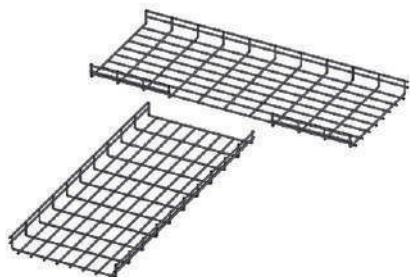

Straight Sections

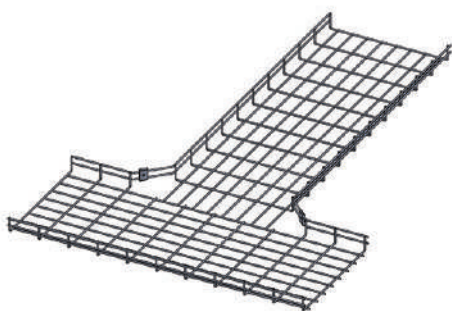

Short Radius

Horizontal Cross

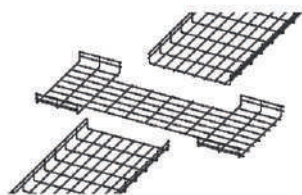

Straight Sections

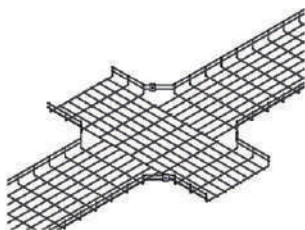

Short Radius

Horizontal Reducer

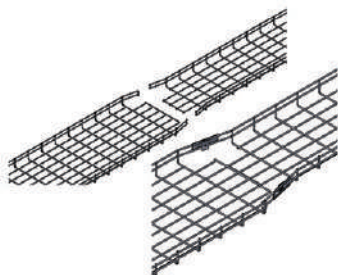

Horizontal Center Reducer

Accessories



Clamp assembly

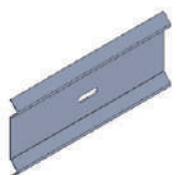

Hold down clamp

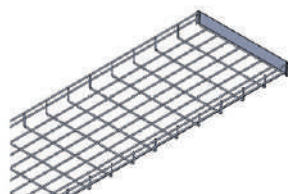

Blind end

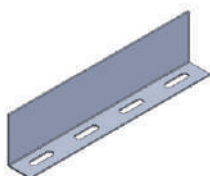

Straight element separator

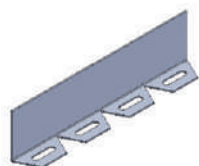

Horizontal elbow separator

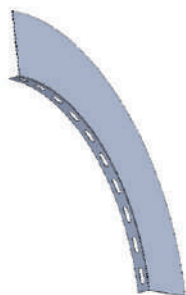

Straight element vertical



Vertical inside separator



Support System

Profiles

Material

Steel 37 - Stainless steel (304 - 304L - 316 - 316 L) - Aluminum (6063)

Finish

Hot dip galvanized after fabrication
Electro plated
Electro static coated

Technical Data

Standard length (2000 - 3000 - 6000 mm) - Standard thickness (2 - 2.5 - 3 - 4 mm)

Unistrut

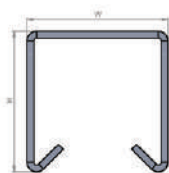

U-41x41
Single channel

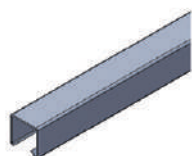

Solid channel
SU-41X41

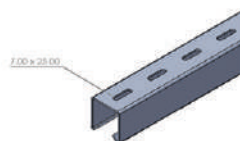

Perforated
PU-41X41

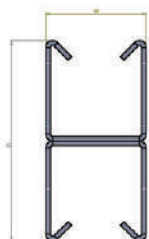

DU-41x41
Double channel

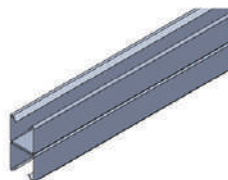

Solid channel
SDU-41X41

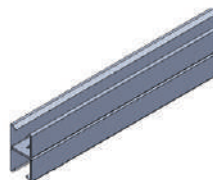

Perforated
PDU-41X41

C Profile

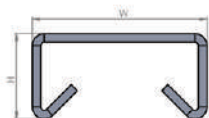

C - WxH
Single channel

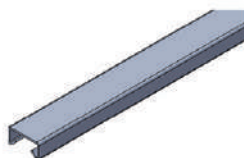

Solid channel
SC - WxH

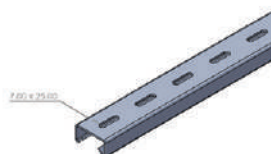

Perforated
PC - WxH

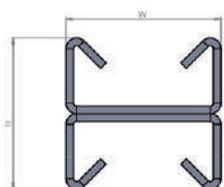

DC - WxH
Single channel

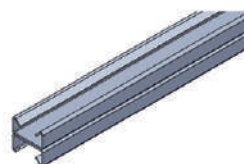

Solid channel
SDC - WxH

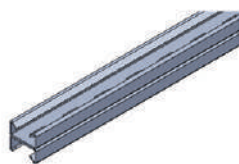

Perforated
PDC - WxH

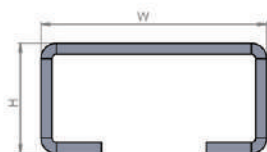

CH - WxH
Single channel

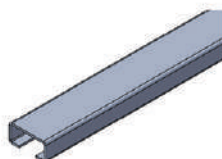

Solid channel
SCH - WxH

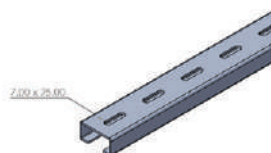

Perforated
PCH - WxH

Available sizes for C channel

W	H	Thickness
40	25	1.5 - 2 - 2.5 - 3
41	41	1.5 - 2 - 2.5 - 3
50	25	1.5 - 2 - 2.5 - 3

U Channel

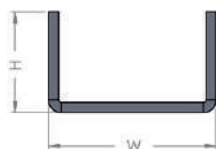

UC - WxH

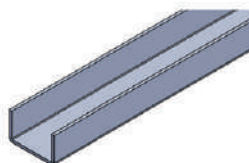

Solid channel (SUCH)
PUC - 50X25

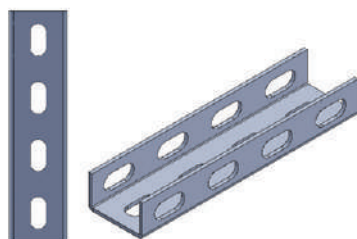

Perforated Channel 50x35 mm
PUC - 50X35

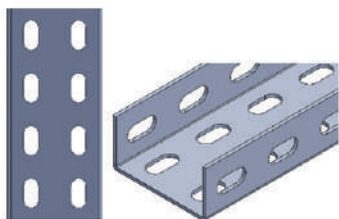

Perforated Channel 90X45 mm
PUC - 90X45

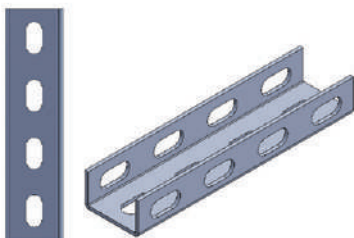

Perforated Channel 50X25 mm
PUC - 50X25

Available sizes

W	H	Thickness
50	25	1.5 - 2
50	30	1.5 - 2 - 2.5 - 3
50	35	1.5 - 2 - 2.5 - 3
90	45	1.5 - 2 - 2.5 - 3

Omega Channel

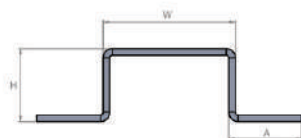

OC - wxhxa

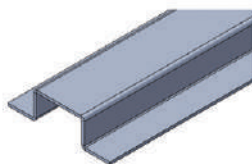

Solid Omega channel
SOC - wxhxa

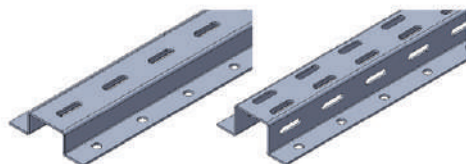

Perforated Omega Channel (POCH)
POC - wxhxa

Angular Omega

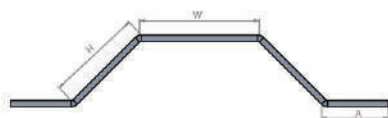

OA - wxhxa

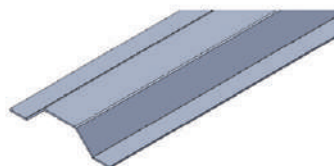

Solid Omega channel
SOA - wxhxa

Available sizes

W	H	a	Thickness
25	25	25	1.5 - 2 - 2.5 - 3
50	25	25	1.5 - 2 - 2.5 - 3
50	50	25	1.5 - 2 - 2.5 - 3

Another sizes are up on request

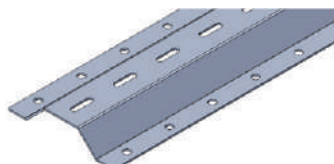

Perforated Omega
POA - wxhxa

Z - Channel

Available sizes

A	B	C	Thickness
25	25	25	2 - 2.5 - 3
25	50	25	2 - 2.5 - 3
50	50	50	2 - 2.5 - 3

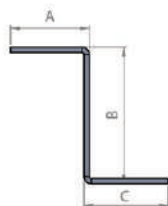

Z - AxBxC

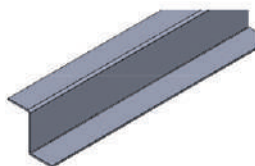

Solid Z channel
SZ - AxBxC

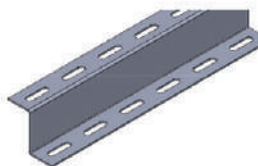

Perforated Z channel
PZ - AxBxC

Angular Omega

Available sizes

B	A	C	Thickness
75	50	15	2 - 2.5 - 3
100	50	15	2 - 2.5 - 3
150	50	15	2 - 2.5 - 3

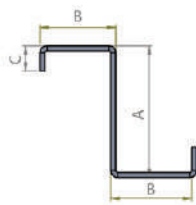

ZC - AxBxC

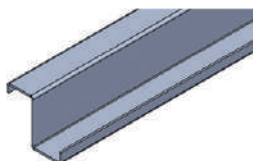

Solid Z channel
SZC - AxBxC

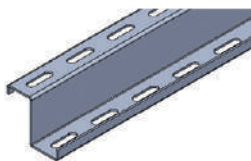

Perforated Z channel
PZC - AxBxC

Equal - L - Angle

Available sizes

A	B	Thickness
30	30	2 - 2.5 - 3
40	40	2 - 2.5 - 3
50	50	2 - 2.5 - 3
70	70	2 - 2.5 - 3

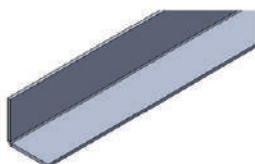
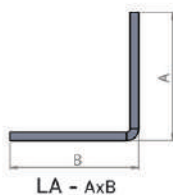

Solid equal
SLA - Ax B

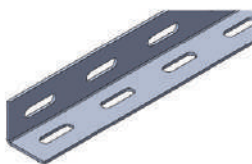

Perforated equal
PLA - Ax B

Un Equal - L - Angle

Available sizes

A	B	Thickness
30	60	2 - 2.5 - 3
40	80	2 - 2.5 - 3
50	100	2 - 2.5 - 3

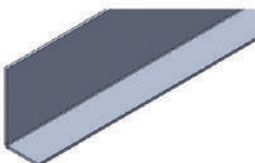
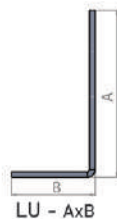

Solid Unequal
SLU - Ax B

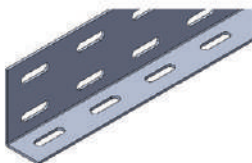

Perforated Unequal
PLU - Ax B

I Beam

Material
Steel 37

Finish
Hot dip galvanized after fabrication
Electro plated
Epoxy coated



Available sizes

H	b	Length
100	50	1000 - 2000 - 3000 - 6000
80	40	1000 - 2000 - 3000 - 6000



SL - Hxb



PL - Hxb

T Beam

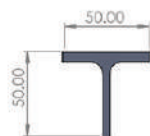

Available sizes

H	b	Length
40	40	1000 - 2000 - 3000 - 6000
80	80	1000 - 2000 - 3000 - 6000



Accessories

Unistrut accessories

All the following accessories beam clamps, plates, angles & base plates have the same properties of C profile support system in Material, Finishes . (ASTM A108 or ASTM A36)

Material

Steel 37

Stainless steel (304 - 304L - 316 - 316 L)

Finish

Hot dip galvanized after fabrication

Electro plated

Electro static coated

Spring nut Electro plated only

Beam Clamps

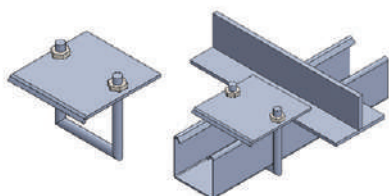

Beam clamps for single channel
(thickness 6-8-10mm)
(BCSU)

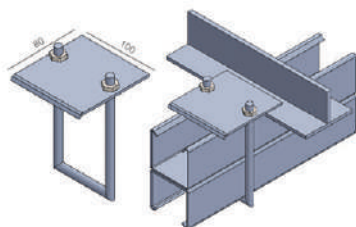

Beam clamps for double channel
(thickness 6-8-10mm)
(BCDU)

Base plate

Thickness (6-8-10 mm)

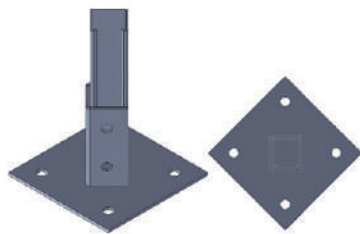

Base plate for single channel
(BPSU)

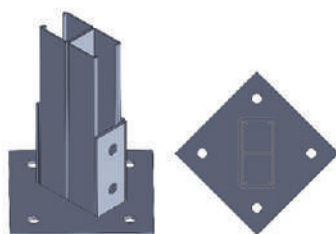

Base plate for double channel
(BPDU)

Brackets

C Profile Bracket (CB)

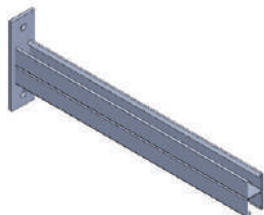

Channel length: Cable tray width + 30 mm
 Channel thickness: 2 mm for tray width (100 to 300)
 2.5 mm for tray width (400 to 1000)

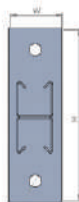

Weided plate size: 200x60 mm
 Weided plate thickness: 6 mm for tray width (100 to 300)
 8 mm for tray width (400 to 1000)

Wall Bracket with weided plate (WB)

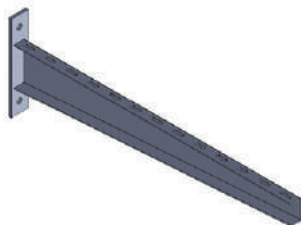

Bracket length: Cable tray width + 30 mm
 Weided plate size: 200x60 mm

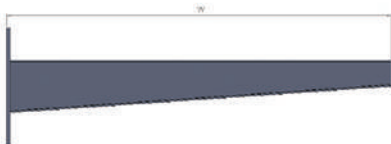

Bracket thickness: 2 mm for tray width (100 to 300)
 3 mm for tray width (400 to 600)
 Weided plate thickness: 6 mm for tray width (100 to 300)
 8 mm for tray width (400 to 600)

I Beam Bracket with weided plate (IB)

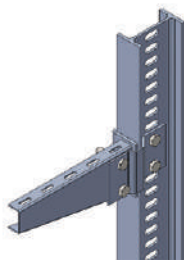

Bracket length: Cable tray width + 30 mm

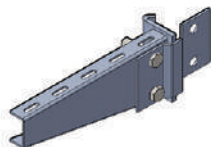

Bracket thickness: 2 mm for tray width (100 to 300)
 3 mm for tray width (400 to 600)

U Channel Bracket (UB)

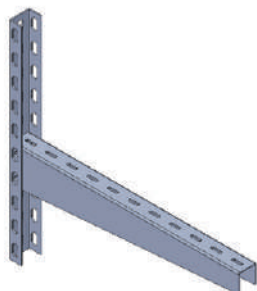

Bracket length: Cable tray width + 55 mm
U channel size: 50x25 mm , 250 mm length
90x45 mm , 250 mm length

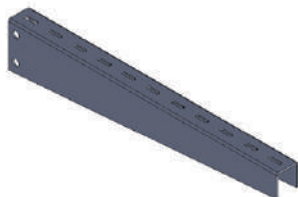

Bracket thickness: 2 mm for tray width (100 to 300)
3 mm for tray width (400 to 600)
U channel thickness: 6 mm for tray width (100 to 300)
8 mm for tray width (400 to 600)



Wall (L) Bracket (LB)

L Bracket length: 150 X 100 mm for Cable tray size (50-100) mm width
300 X 150 mm for Cable tray size (150-200) mm width

L Bracket thickness: 2 mm thickness

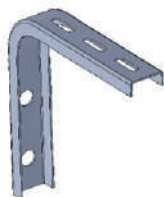

Wall Omega (WO)

Omega thickness: 2 mm thickness for cable trays width from (100 to 300 mm)
3 mm thickness for cable trays width from (400 to 600 mm)
4 thickness for cable trays width from (80 to 1000 mm)

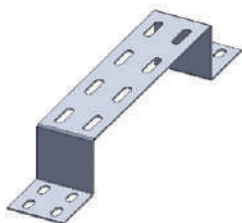

Ceiling support (CS)

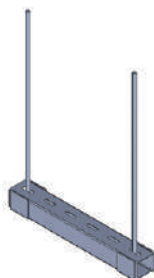

Channel length: cable tray width + 100 mm
Channel thickness: 2 mm for tray width (100 to 300 mm)
3 mm tray width (400 to 1000)



Threaded rod length: 1000 mm
Threaded rod size: 6 mm for tray width (100 to 200)
8 mm for tray width (300 to 400)
10 mm for tray width (500 to 600)
12 mm for tray width (up to 1000)

Ceiling hanging support (CH)

This support for small sizes of cable trays

Cable trays size: (50 - 100 - 150 - 200) mm width
Threaded rod size: 6 - 8 mm diameter





 Industrial Zone, Qaliuob, Qalioubya Gov., Egypt.

 Sales@metaltech-eg.com

 02 42193064

 012 8281 8209 - 012 1192 2567 - 011 1701 7158

 metaltech-eg.com

